



Waukegan Harbor Citizens' Advisory Group

P.O. Box 297

Waukegan, Illinois 60079

<http://waukeganharborcag.com>

Minutes of the February 19, 2015, CAG meeting held at Lilac Cottage, Waukegan Park District, Waukegan respectfully submitted by Natalie Dutack, acting as Recording Secretary of the Waukegan Harbor Citizens' Advisory Group.

The February 19, 2015, meeting of the Waukegan Harbor Citizens Advisory Group was called to order at 6:08 pm by Chair, Susie Schreiber.

The Chair welcomed those in attendance and asked everyone to identify themselves and any group that they represent.

Attendance at the February 19, 2015 CAG Meeting:

Penny Bouchard	Concerned Citizen
Larry Brewer	Concerned Citizen
Tom Chefalo	Lake County Planning, Building & Development
Natalie Dutack	GLRI Quality Assurance Manager
Claudia Freeman	Waukegan Park District
Paul Geiselhart	Lake County Audubon
Joe Hmieleski	Project Manager – Waukegan Dunal Area
Bill Lebensorger	GLRI Grant Administrator
Alex Morgan	Sierra Club
Steve Robillard	IDNR
Rich Romanek	National Gypsum
Diane Tecic	IDNR
Mike Trigg	Waukegan Park District
Fred Veenbaas	NRG, Inc. Waukegan Station
Wayne Schimpff	Concerned Citizen

GUESTS:

Barb Cornew	Concerned Citizen
Barb Eikenberry	USGS
Jared Dellinger	League of Women Voters & Concerned Citizen
Larissa Herrera	Huff & Huff
Charlie Hoffman	Lake Forest Open Lands & Concerned Citizen
Roger Klocek	Huff & Huff

AGENDA

No additions to the agenda.

MINUTES

There were some small typos in the February minutes. Motion to approve the minutes with corrections noted was made by Paul Geiselhart and seconded by Larry Brewer. The motion was approved and passed.

UPDATES

USEPA

Johns Manville Corp. Superfund Site

Dredging of sand from the Borrow Pit Area continues and is expected to be complete by early March. Utility agreements and work plans are being negotiated in preparation for the Southwestern Site Area cleanup.

NRG Energy is going to move a portion of their sand to the Industrial Canal. The remaining sand will stay on the NRG property as is.

Outboard Marine Corporation

After the City of Waukegan's demolition of the Triax Building, the sole remaining building at the OMC Plant 2 site, the USEPA plans to remove the contaminated concrete and soil below that building for offsite disposal. Work is estimated to be complete in early summer.

The USEPA plans to resume work on the Old Die Cast containment cell and the nearby utility corridor in the spring and complete that work in early summer of 2015.

Shakedown work continues on the newly installed Water Treatment Plant for produced water from the West Cell, Old Die Cast Cell, and the Consolidation Facility. The USEPA contractors will continue to operate the Water Treatment Plant for much of 2015.

The USEPA will be evaluating the site groundwater in the next few months to determine if more treatment is needed in 2015.

Yeoman Creek Landfill

The Yeoman Creek Remediation Group (YCRG) has been submitting routine progress reports with respect to the actions and routine monitoring activities undertaken by the YRRG related to the long term operation and monitoring of the Yeoman Creek Landfill Site.

The Phase 2 protective measures proposed by the YCRG are being further refined. On February 6, 2015, the USEPA and its technical contractor participated in a detailed technical discussion with the YCRG subject matter experts and other representatives regarding the technologies and remedial action plan for the additional Phase 2 protective measures in the parking lot and back yard areas of the Terrace Nursing Home. Based on the discussions held on February 6, the USEPA is planning to submit written comments within a week.

Manufactured Gas Plant Sites

South Plant: USEPA is currently reviewing responses to the focused feasibility study (FFS) for remediating free product (DNAPL) underneath the site. The USEPA will be providing comments, if any, by early March. A decision on a cleanup plan for free product is targeted before the end of summer.

North Plant: No updates at this time.

IDNR – Diane Tecic

John Legge, formerly with the IDNR Coastal Zone, has taken a position with the Nature Conservancy. We are down some staff and may not be able to attend some meetings, but hopefully not for long.

IDNR has been working with Alliance for the Great Lakes on sand management issues all along the North Shore. The first kick off meeting, on March 9, 2015, is focused towards getting mayors and city managers on board to figure out how we can work together as a region to address this issue. After we work with municipalities, we will look to the broader stake holders. Six (6) months has been allocated by IDNR to work on-Lake Michigan coastal sand management issues and get some strategies in place.

Preliminary discussions have been held with the Illinois Natural History Survey and the Illinois Coastal Management Program to create an Research and Education Center in Waukegan. It would be a great place to showcase the clean harbor and habitat. Details will take a while to sort through. We have already spoken with the City of Waukegan and the Waukegan Port District and they are both interested.

IDNR has contracted with the United States Geological Suvery (USGS) for benthos monitoring in Waukegan Harbor this summer.

Questions

You mentioned the research center before, but you were looking at Evanston. What happened?
That fell through. The site had limitations and we couldn't have the partners we would in Waukegan.

City of Waukegan

No report.

CAG BUSINESS

Siberian Express Cold Front Map

We are passing around a Siberian Express Cold Front map of the weather conditions beginning in Russia and flowing across North America to the Great Lakes., It is currently colder in Waukegan than in Lake Baikal!

Nominating Committee – 2015 Waukegan Harbor CAG Executive Committee - Election

The nominating committee presented the following slate for the 2015 Executive Committee:

Susie Schreiber - Chair

Penny Bouchard - Corresponding Secretary

Larry Brewer - Treasurer

Don Wilson - member at large

Paul Geiselhart - member at large

Fred Veenbass - member at large

Claudia Freeman asked if there were any nominations from the floor. With none, Diane Tecic made a motion to accept, which was seconded by Roger Klocek. All were in favor and the motion carried.

Recent Waukegan Lakefront pictures

Susie shared pictures taken two weeks ago at the Waukegan lakefront showing the current conditions of the shoreline and waste receptacles. The Waukegan Port District Garbage can lids have arrived! They have installed a unit inside the lid that keeps raccoons and other animals from getting in. The Waukegan Port District has installed them along south sea wall where they look clean and very nice.

Lake County Health Department – Response to Eco Ambassador’s Trash Management Report

The report created by our 2014 Summer Interns was clear and concise. The Lake County Health Department reviewed the report and gave the following response:

The Lake County Health Department (LCHD) annually monitors water quality conditions during the swimming season along the Lake Michigan shoreline in Lake County, including at both the North Beach and South Beach in Waukegan. In 2014, a report was submitted to various groups and agencies (including LCHD) by the Waukegan Citizen’s Advisory Group based on work completed by interns with the Eco-Ambassador program. The report was authored by intern Oscar Cornejo, a Dartmouth College student who worked on the project in 2014. We would like to point out a couple questions/issues pertaining to the report that are important public health issues at the lakefront that we would like the Committee to consider.

Dead Animals

Currently, it is our understanding that the protocol for disposing of dead animals is to bury them on the beach where they are found. We recommend the following protocol:

- *All dead animals should not be buried, but removed from the beach area as soon as possible and disposed of in the trash.*
- *Wear disposable gloves.*
- *Place animal in a plastic garbage bag. This can be done by hand or with a shovel.*
- *Place the first bag into a second plastic bag. This is done to prevent leakage of any fluids that may accumulate in the first bag.*

- *Discard the bag immediately in the trash. Do not place in outside trash bins that may not be emptied for several days.*
- *If large numbers of animals (>10) are found at once, do not remove the animals, but contact either LCHD or the Illinois Department of Natural Resource as this may be indicative of a disease.*

Immediate removal of dead animals is important to prevent attracting scavengers and reducing the spread of potential pathogens. Buried animals may be uncovered by animals or even people at the beach.

Trash Cans

Accumulation of trash can attract animals such as gulls, which have been identified as the one of the primary contributors of E. coli bacteria in the waters at the swimming beaches. We recommend trash pickup daily, with emphasis on days immediately following a weekend or holiday. Covered trash cans are preferred to prevent animals from accessing the garbage and from rain accumulating in the cans. We support the recent efforts to install more Big Belly trash bins, as many of the current, non-Big Belly, open cans are often overflowing and winds blow trash around the lakefront.

Bowen Park Frog Pond renovation work – Mike Trigg, Waukegan Park District

Mike Trigg passed out the sign received for the *Chicago Wilderness Conservation and Native Landscaping Award* and the certificate recognizing the Waukegan Harbor CAG as a significant partner. The sign will be posted in Bowen Park, and the certificate will be in the CAG office.

One of the components of the 2010 GLRI Grant was restoration of the Frog Pond. A portion of the GLRI grant money is going toward the Waukegan Park District's Bowen Park Morrison Shelter Improvement and Ravine Enhancement Project. The Waukegan Park District worked with Hey and Associates to create the project plan.

Frog Pond Buffer

With the 2010 GLRI Grant funds, the Park District will work on expanding the wetland buffer area with more natural vegetation. The order for seeding and plug materials has been placed. The work will begin in late April / early May 2015. A variety of plant types for wet mesic areas were selected. The Waukegan Park District is also looking into making this into a community planting program.

Morrison Shelter

There was a need to expand the Morrison shelter due to high use. Rather than just using concrete, permeable pavers will be used. The pathways will be expanded using permeable pavers and a boardwalk, similar to those at Roosevelt Park. The goal is to both encourage higher educational usage and protect the natural areas. Another feature will be a loop trail with an overlook viewing the ravine. Work will begin in April/May.

Scans of handouts follow:

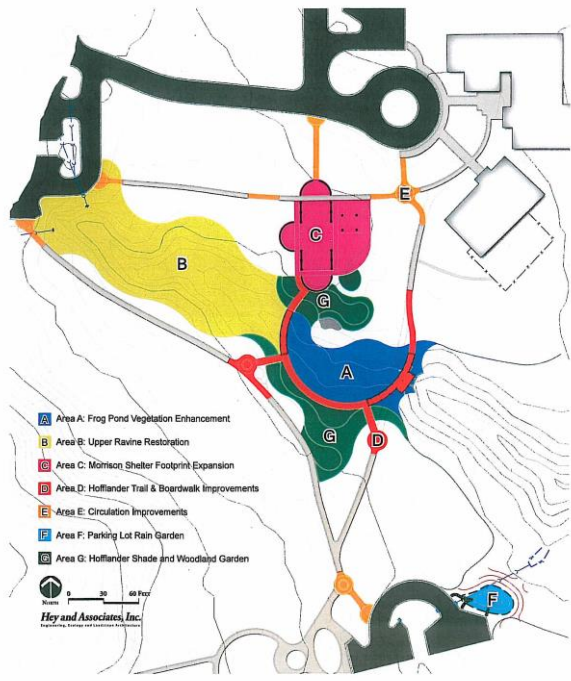

Other Project Components

The Park District is looking at other grant funding, particularly for the rain garden project. This will be located just northeast of the southern parking lot, and gather drainage/ runoff before it reaches the ravine.

The previously established Hofflander Wildflower Refuge, a shade and woodland garden, can potentially be expanded with new plant material as well. That is one of the final phases of the plan. The Park District has a design and will work on different segments as we get the funding.

Thanks to CAG and the GLRI Grant, but also thanks to Margo Milde and Wayne Schimpff for their data collection and baseline work establishing the quality and importance of the site!

Illinois Audubon – Bowen Park Chicago Wilderness Award write up in winter magazine

There will be a write up on Bowen Park in the Illinois Audubon winter magazine about the Waukegan Park District’s award.

IDNR Benthic BUI Sampling Plan for Waukegan Harbor – Barbara Eikenberry

Barbara is with the USGS Madison area Wisconsin Water Science Center.

We were approached by the IDNR to do the 2015 benthic sampling of Waukegan Harbor. We will conduct assessments of Waukegan Harbor AND a similar non-AOC harbor.

Waukegan Harbor was compared with Burns Harbor, but Winthrop and Kenosha Harbor are also

possibilities. Burns Harbor is similar to the Waukegan site as it is man-made, with a lot of large ship traffic. It is not unimpacted, but there are no truly un-impacted harbors to compare with Waukegan.

Benthic sampling was done by Battelle in Waukegan Harbor in 2012, a year with quite a drought. A lot of high heat may have negatively affected these aquatic communities and sampling results that year.

The proposed 2015 sampling locations are:

- North Harbor
- Inner Harbor
- Waukegan Outer Harbor

Barbara shared a picture and noted that they would sample three sites indicated on it if they choose Burns as the site.

Sampling will begin in early June and mid-August 2015. We will be using a boat and recording locations with GPS and looking at the following data sets:

- Water quality temperature, pH, and conductance.
- Plankton – We will be using whole water samples for diatoms, soft algae, chlorophylls, and algal biomass, and gather samples from the water at different depths. We will also use plankton nets to gather micro-crustaceans and rotifers.
- Benthos - Ponar Dredge will be used for worms, midges, and bottom dwelling invertebrates. We will also take substrates of sand/silt/clay to see what the bottom is like. This material will be put through a sieve to get larger invertebrates as well. Artificial substrate (H-D samplers) will be used to study midges, zebra mussels, and other bottom dwellers. These samplers will be attached along a pier or wing wall. Specimens will crawl into the fake substrate, and we can gather them later.

We will be looking at the following datasets / metrics as part of data analyses:

- Compute biological measures or metrics
 - Record Taxonomic ID and abundance of plankton and benthos
 - Note the number of unique taxa (species richness)
 - Note the top 5 most dominant species
 - Index of Biotic Integrity will be calculated for the H-D samplers only.
- Compare AOC and Non-AOC
 - We will look at changes/ similarities within seasons and;
 - Across seasons.

The sampling schedule is as follows:

- Deploy H-D samplers April 27/28 and June 30/July 1, 2015
- Sample and retrieve H-Ds June 8-11, August 10-13, 2015

Analysis and report writing will follow, and hopefully we will report back to the Waukegan Harbor CAG in a year with the results.

Questions

A lot of the harbor was dredged in July of 2013. Will it have recovered? Hopefully, yes.

Do you normalize for depth or does that matter?

We are limited in depth by the length of cable (20-25 feet) so we will be in shallower areas. We try to keep it in similar depths. ~~Susie noted that~~ Waukegan Harbor is only 18' deep, so this will be fine.

This data will be used for what?

We are looking to see if there is a big difference in benthos here and at the non-AOC site. The IDNR would make any recommendations. It was noted that we are looking at the benthos prior to clean-up and after clean-up.

Report on Macroinvertebrate index of Biotic Integrity for Waukegan Dunal Area and Bowen Park – Larissa Herrera, Huff & Huff

Macroinvertebrates are animals without backbones found in rivers, streams, lakes, and ponds. They can be used to assess water quality. The goal of our work was to:

- Provide a baseline study of what was in both the Waukegan Dunal Area and Bowen Park.
- Make recommendations based on what we found.

Species

Macroinvertebrates have different levels of tolerance. Tolerant organisms live in a wider range of conditions. A body of water with primarily tolerant species could use some remediation. Generally, **you want to find intolerant species**, which prefer high quality bodies of water. If there is a high number of intolerant species, the site is good (high oxygen levels, moving water, large/coarse substrate, less pollution and development). The most sensitive taxa found at all the sites were scuds. These are good food for fish, frogs, tadpoles, and other creatures.

Substrate

Typically a high quality stream will have riffles which have faster flowing water, more oxygen, and coarser substrate. You will find more intolerant species in these areas.

At Bowen we selected three sites:

- WR-1 had riffles and good substrate, making it the best location.
- WR-2 is the second nicest site. There are riffles, but there is also bank erosion and debris blockage.
- WR-3 had silt substrates and no riffles. It was very mucky, with good vegetation, and a lot of large dragonflies. This area was a pool and had the lowest quality species.

The Dunal Area had four sites:

- WB-1 had algae problems later in the summer.
- WB-2 had a nice infusion of Lake Michigan water.
- WB-3 is next to a giant woody debris pile. Benthos like this type of structure, which provides habitat and food. There were no intolerants but a lot of other species.
- WB-4 connected to Lake Michigan in the spring and had very different results across the seasons.

It is important to note that the Waukegan Dunal Area dune and swale system won't rank high on a quality index because it is not a stream.

Results

We assessed the samples using two methods:

Macroinvertebrate Biotic Index (MBI)

- This is calculated using a numerical rating of each taxa.
- Each taxa has a rating of 0-11, with 0 being the most sensitive/intolerant. A lower score is better, as it means you have more sensitive taxa.
- For our sampling, WB-4 had the lowest MBI of all sites at in the dunes for the spring sampling. At Bowen, WR-1 had the lowest MBI in summer and fall, but spiked in the spring. WR-2 was similar through all seasons, and just a little higher than the WR-1 lows overall.

Macroinvertebrate Index of Biotic Integrity (MIBI)

- Created by the Illinois EPA.
- Looks at the total number of taxa, not tolerance.
- More commonly used due to the resolution of detail.
- For MIBI it is better to have a high score.
- WB-4 at the Dunes and WR-2 at Bowen had the highest MIBI's, however all the sites were classified as FAIR.

The final results show that species were primarily in the middle – neither tolerant nor intolerant. All sites were generally fair, though some came out as poor in certain seasons.

At Bowen Park the two upstream sites both (WR-1 and 2) are better. WR-2 had TWO intolerant organisms. One was surprising and exciting - an intolerant dragonfly! All three of the river sites have detritivores. They eat garbage, and by their presence, you would assume that there is something “not good” in the water. It could be flashy or not flowing at some times of the year.

The Waukegan Dunal Area dune and swale system has less unique taxa than the stream system. Species are not very abundant, and that is not good for the overall community. Dune and swale sites primarily had predator species which was surprising.

Recommendations:

Bowen

The habitat is there but there may be a hydrology issue. It could be that water is being diverted upstream. You need water to reestablish benthic communities. This could be achieved by having more pools. Removal of the debris blockage near WR-2 and addressing erosion will also help.

Dunes

Increase the food base at the dunes and don't leave phragmites in swales. It releases phosphorus as it decomposes, which decreases the oxygen load in the water. We don't know what nutrients are in the water, but based on algae growth we know there is something. A water test would be helpful.

Adding more driftwood and root wads will increase habitat.

Chicago Wilderness - Goals for 2015 to 2020 - report

The Chicago Wilderness is realigning their original goals and creating a new 5 year goal and work plan. These will be posted on the website so we can see the recommendations. They previously had 41 focus areas which they have condensed down to 6. They will continue work on the other areas, but in different formats. The six focus areas are:

- Oak Ecosystems

- Species of conservation concern
- Water as a resource
- Landowners
- Public Engagement
- Member tools

This is a strategic alignment and the new goals will have a solid science background and collective engagement.

Questions

Did they get a new person for Leave no Child Inside?

We don't know. We may learn more at the CW - LNLI meeting in early March.

Birding Lake County – Economic Study

An article published this week in the Chicago Tribune noted that birding may be bringing a “modest economic boost” to Lake County. Natural areas are drawing birders from outside of the county, who spend money in Lake County. Restoration of avian habitat will help continue this trend. Please read more at: <http://www.chicagotribune.com/suburbs/lake-county-news-sun/lifestyles/ct-lake-county-birding-met-20150217-story.html>

Solar power – mirrors – solar towers and bird problems

There is a study showing a correlation between mirrors on solar towers and negative effects on insects and birds. As with any technology, we are still learning and making adjustments.

Great Lakes Commission – Winter 2014-2015 report

The winter 2014-2015 report just came out in the mail. It references the new Water Resources and Development Act (WRRDA). Susie read from the following paragraphs:

The authorization bill also includes major reforms to the Harbor Maintenance Trust Fund (HMTF), which is fed by the Harbor Maintenance Tax (HMT) on waterborne cargo. It is estimated that by the beginning of FY2015, the surplus of HMT collections over expenditures will grow to approximately \$8.5 billion. Rather than being used for their intended purpose, these user fees are instead siphoned off to balance the federal budget each year.

The newly enacted WRRDA aims to balance HMTF revenues with expenditures by 2025. It also provides three set asides or “funding buckets” applicable to the Great Lakes. The first is a specific Great Lakes set aside of 10 percent above FY12 levels for Great Lakes ports. The second and third specifically set aside five percent for “Emerging Harbors” and 10 percent from overall HMTF expenditures for “Underserved Harbors.”

The full report is available online. This information will be part of upcoming meetings. What is important to note is that there is funding, and we want to make sure we can get part of that for projects like the seawall on the north side of the Entrance Channel.

Great Lakes Small and Medium Harbors – status and funding

There is an upcoming stakeholder meeting on shallow draft recreational harbors hosted by the USACE Detroit District. There is an option to attend via teleconference and webinar as well. Additional funding for ongoing work is available. If you want to attend please let us know. We will post the presentation to the website.

Larsen Marine – current educational opportunities at the harbor

The following opportunities are available through Larsen Marine on February 21, 2015:

- Your Great Loop Adventure – 9:30 to 10:45 a.m.
- VHF and cell phones on the Great Lakes – 10:45 a.m. to 12:00 p.m.
- Knots and Splicing – 12:30 to 1:30 p.m.

Waukegan Park District Live Green Festival – Bowen Park - Sunday, May 17, 2015

The Live Green Festival has been scheduled for May this year, as it was too cold in April last year! Attendance numbers were greatly impacted affected by the weather, but there was excellent turn out in 2013 in sunnier conditions. Mark your calendars and join us!

Midwest Great Lakes Society for Ecological Restoration - Bowen Park site tour – March 29, 2015

The Midwest Great Lakes Society for Ecological Restoration is partnering with Northwestern University and the Chicago Botanic Garden for their 2015 meeting at the end of March. On Sunday, March 29, 2015 they will come to Bowen Park for a site tour. The Chicago Botanic Garden recommended Bowen Park's ravine system as a priority site tour because all of the high quality species inventories and restoration work that has been done!

AOC meeting Toledo – March 11 -12, 2015 – University of Toledo

This is a well attended event in which all 31 US Areas of Concern convene annually to discuss progress, issues, and updated Delisting and Recovery criteria with the USEPA and the Great Lakes National Program Office. We will have four representatives present to represent the Waukegan Area of Concern and Extended Area of Concern. There will be a report at the next CAG meeting.

OLD BUSINESS

Nothing to report

NEW BUSINESS

The following events are coming up in the near future:

- To Tend the Earth: Responding to the Global Climate Change Crisis – Loyola University – March 19-20, 2015
- Water Summit – Milwaukee, Wis. – June 23 and 24th, 2015
- Great Lakes Days – Great Lakes Commission Semi Annual Meeting- Washington D.C. Feb. 24-25, 2015

ADJOURNMENT

A motion to adjourn was made by Claudia Freeman, and seconded by Penny Bouchard. The motion passed and the meeting ended at 8:07 p.m.

CAG Members

*Abbott Laboratories
Akzo Nobel
Alliance for the Great Lakes
Bombardier Recreational Products
Carol Dorge, Attorney
City of North Chicago
City of Waukegan
College of Lake County
Commonwealth Edison
Great Lakes Sport Fishing Council
Illinois Audubon Society
Johns Manville
LaFarge Corporation
Lake County Audubon
Lake County Chamber of Commerce
Lake County Planning, Building and Development Dept.
Lake County Health Department
Lake County Stormwater Management Agency
Larsen Marine, Inc.
LFR Levine • Fricke
Liberty Prairie Conservancy
Midwest Generation
National Gypsum
North Shore Gas
North Shore Sanitary District
Outboard Marine Corporation
Salmon Unlimited
Sierra Club – Illinois Chapter*

CAG Members (continued)

*Waukegan Charter Boat Association
Waukegan Main Street
Waukegan Lakefront Development Corporation
Waukegan Park District
Waukegan Port District
Waukegan Yacht Club
Concerned Citizens*

CAG Associates

*Chicago Metropolitan Agency for Planning
Delta Institute
Illinois Citizen Action
Illinois Department of Natural Resources
Illinois Environmental Protection Agency
Illinois-Indiana Sea Grant
Illinois Lake Management Association
Illinois Pollution Control Board
International Joint Commission
Maritime Administration
U.S. Army Corps of Engineers
U.S. Environmental Protection Agency
U. S. Fish and Wildlife
University of Illinois- Marine Extension
Waukegan Public Library
Concerned Citizens*

WEB SITES

<http://www.waukeganharborcag.org>

The Waukegan CAG website.

<http://www.epa.state.il.us/environmental-justice>
<http://www.ilenviro.org>

Illinois EPA – Environmental Justice website.
Good listing of all environmental bills in the IL House & Senate.

<http://www.glc.org>
<http://www.binational.net>

Great Lakes Commission.
Great Lakes Binational Toxics Strategy – Annual Progress Report

<http://www.glerl.noaa.gov/pubs/brochures/wlevels/wlevels.html>

Great Lakes Water Levels

<http://www.cciw.solec>

State of the Great Lakes – SOLEC full report

<http://www.epa.gov/glnpo/solec>

<http://www.lkmichiganforum.org/>

The Lake Michigan Forum

<http://www.epa.gov/glnpo/lakemich>

Lake Michigan Lake Wide Management Plan (LaMP 2000)

<http://wi.water.usgs.gov/lmmcc/index.html>

Lake Michigan Monitoring Coordinating Council

<http://www.epa.gov/lakemich>

Lake Michigan Sensitive Areas

<http://www.sph.umich.edu/ehs/umaql/mass.html>

Lake Michigan Mass Balance Study

<http://www.epa.gov/glnpo/lmmb>

Lake Michigan Mass Balance

<http://biology.usgs.gov/S+t/noframe/x186.html>

Zebra Mussels in Southwestern Lake Michigan

<http://www.gvsu.edu/wri>

Annis Water Resources Institute

<http://www.epa.gov/OST/GLI/glimixqa.html>

A document on Bioaccumulative Chemicals of Concern (BCCs)

USEPA WEB SITE

Go the EPA Home site at *epa.gov*

Select *Illinois* from the map. It will go to an Illinois page.

Then select *Outboard Marine Corp Superfund Site* in the *EPA in Illinois* section.

Addition information may be reached by the top right hand box labeled Site Information.

Select *NPL Fact Sheet*. At the bottom you can click on *Site Profile Info* and it will take you to Superfund.

The Superfund Site Progress Profile contains the following additional information on the Superfund sites:

The site, contamination, cleanup progress summary, cleanup impact summary, land re-use, post-construction, five year review and community involvement.

For Area of Concern Information:

Go the EPA Home site at *epa.gov*

Select *Illinois* from the map. It will go to an Illinois page.

Select *Great Lakes Area of Concern* in the *EPA in Illinois* section.

Choose *Waukegan Harbor* for AOC information.